

Leveringsomvang  
 Lieferumfang  
 Scope of delivery  
 Composition  
 Contenuto della fornitura

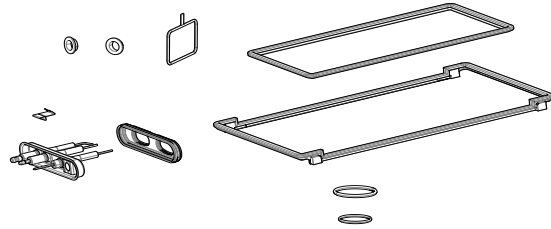

**S5069300 iCon1**  
**S5069400 iCon2**

		S5069300	S5069400
		iCon1	iCon2
01	AFDICHTING VENTILATOR/BOVENBAK iCON GASKET FAN/TOP PART H.EX. DICHTUNG VENTILATOR/MISCHKOPF JOINT VENTILATEUR/TETE MELANG. GUARNIZIONE VENTILATORE UNIT/VENT.	1	1
02	AFDICHTING KOPPELING 3/4"GASBL.SHR GASKET FITTING 3/4"-GAS VALVE. DICHTUNG GASLEITUNG/GASVENTIL JOINT RACCORD 3/4"VANNE GAZ GUARNIZIONE RACCORDO 3/4"-VALV. GAS	2	2
03	AFDICHTING BOVENBAK/BRANDER iCON GASKET TOP iCON DICHTUNG BRENNER/MISCHKOPF iCON JOINT BRÛLEUR / TÊTE MÉLANGE iCON GUARNIZIONE BRUCIATORE/MISCELATORE iCON	1	1
04	AFDICHTING WSSLR/BOVENBAK iCON GASKET BURNERHOOD iCON DICHTUNG WT/MISCHKOPF iCON JOINT CAPOT DU BRÛLEUR iCON GUARNIZIONE CAPPABRUCIATORE iCON	1	1
05	BEVESTIGINGSCLIP ONTSTEKING iCON SPRING FOR IGNITION ELECTRODE iCON FEDER ZÜND-/IONISATIONSELEKTR.iCON CLIP ELECTRODE D'ALLUMAGE iCON CLIP ELLETRODO DI ACCENSIONE iCON	1	1
06	ELEKTRODE ONTSTEKING+AFDICHTNG iCON ELECTRODE (IGNITION) + GASKET ZEUNDELEKTRODENBLOCK ELECTRODE D'ALLUMAGE ELETTRODO ACCENSIONE	1	1
07	O-RING Ø 37.69X3.53 SIFONBEKER iCON O-RING ø37.69X3,5 SYPH.ECONOMIZER O-RING 37.69X3.53 KONDENSATWANNE JOINT RESSERVOIR RECUEILLE CONDENSATS O-RING 37.69x3.53 VASCA CONDENSA	1	1
08	O-RING Ø 28.25X2.62 SIFONPIJP iCON O-RING D:28.25X2.62 O-RING Ø 28.25X2.62 SIPHONROHR O-RING 28.25X2.62 TUBE SYPHON O-RING 28.25X2.624 TUBO SIFONE	1	1

